



ASKING PRICE

**£125,000**

**Grosvenor Place**

North Shields, NE29 0NH

Fresh Property Centre welcome to the market this charming ground floor flat located on Grosvenor Mews, North Shields. This delightful property offers a perfect blend of comfort and convenience, making it an ideal choice for first-time buyers or couples.

Upon entering, you will find a welcoming reception room that provides a warm and inviting space for relaxation and entertaining. The flat boasts two well-proportioned bedrooms, each offering ample natural light and space for personalisation. The kitchen and bathroom are thoughtfully designed, ensuring both functionality and comfort.

Externally there is residents parking, providing added convenience for those with vehicles.

The location on Grosvenor Place offers easy access to local amenities, including shops, cafes, and public transport links, ensuring that everything you need is within reach. Viewing is recommended.

2



1



1





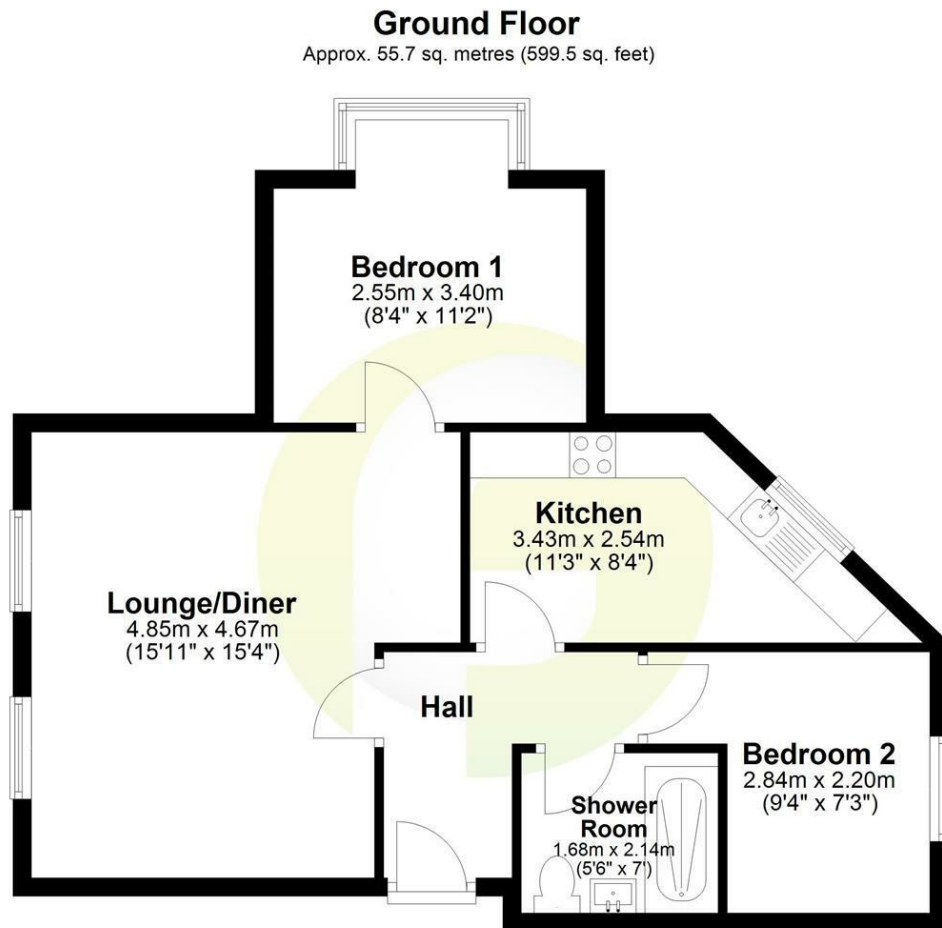

Total area: approx. 55.7 sq. metres (599.5 sq. feet)

**LOCAL AUTHORITY**

North Tyneside

**TENURE**

Leasehold

**COUNCIL TAX BAND**

A

**VIEWINGS**

By prior appointment only

Energy Efficiency Rating		
	Current	Potential
<i>Very energy efficient - lower running costs</i>		
(92 plus) <b>A</b>		
(81-91) <b>B</b>		
(69-80) <b>C</b>		
(55-68) <b>D</b>		
(39-54) <b>E</b>		
(21-38) <b>F</b>		
(1-20) <b>G</b>		
<i>Not energy efficient - higher running costs</i>		
<b>England &amp; Wales</b>	EU Directive 2002/91/EC	

Agents Note: Whilst every care has been taken to prepare these particulars, they are for guidance purposes only. All measurements are approximate and are for general guidance purposes only and whilst every care has been taken to ensure their accuracy, they should not be relied upon and potential buyers/tenants are advised to recheck the measurements



**OFFICE ADDRESS**

63 Church Way  
North Shields  
Tyne & Wear  
NE29 0AE

**OFFICE DETAILS**

0191 257 6823  
hello@fresh.property  
www.freshpropertycentre.co.uk